

# Quick installation manual for the modular roof tile sheet

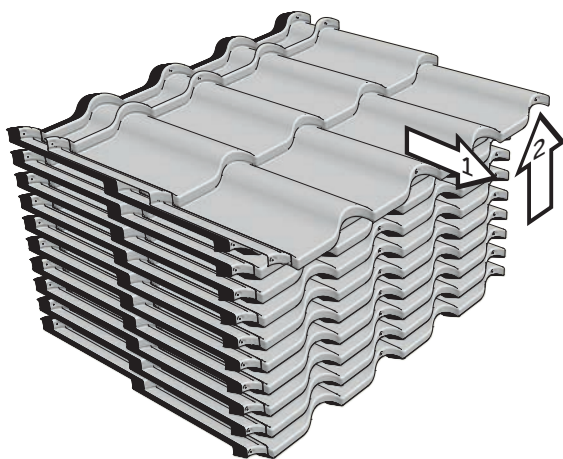

Installation of battens and counter battens,  
eaves solution.

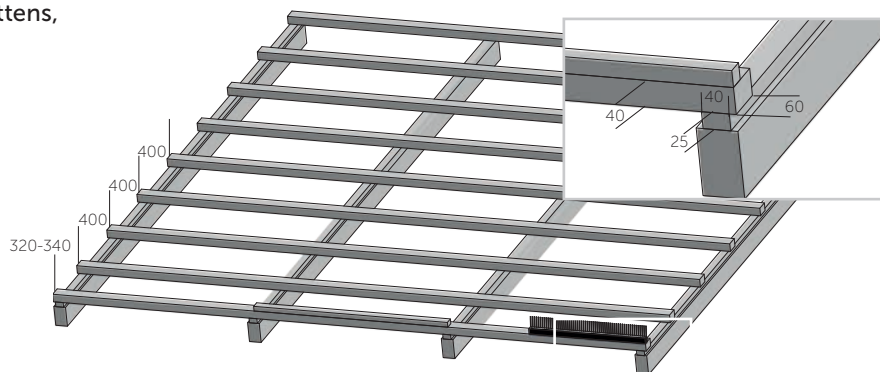

Retrieving sheets from the package.

**Moving the sheets:** The sheets should be carried by their ribbings (green). It is not allowed to move the sheets by their edges (red), as it may cause gaps in the longitudinal overlaps.

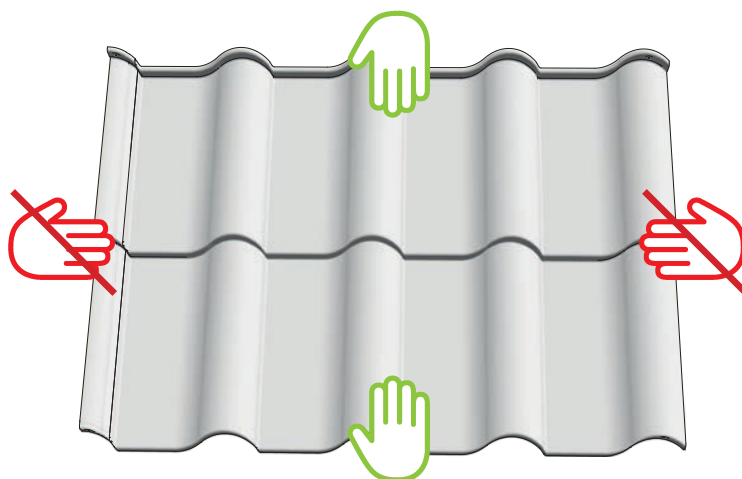

1.

Laying the first sheet on the substructure.

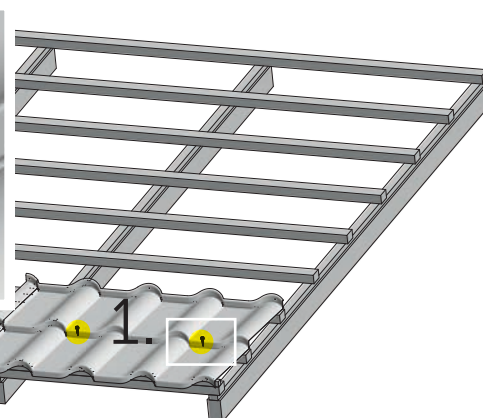
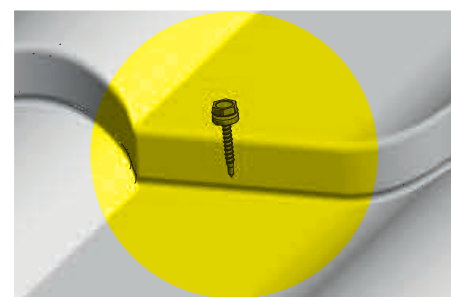
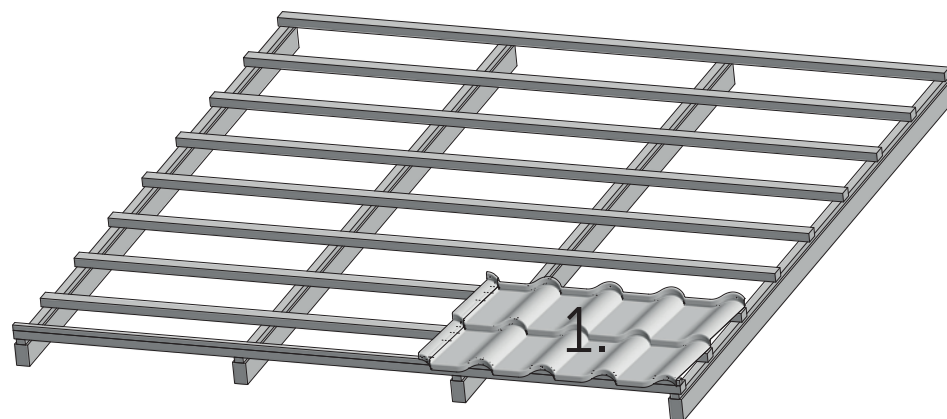

2.

Fixing the first sheet to the battens using TORX LP 4,8 x 38 or 4,8 x 35 farmer screws.

3.

Laying the second sheet.

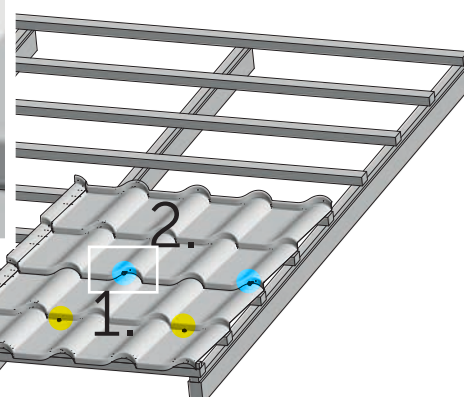
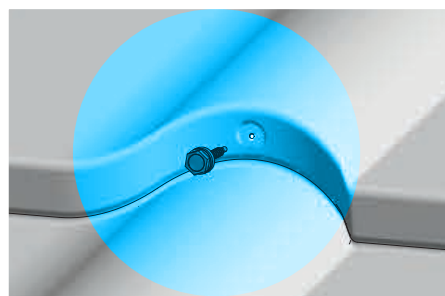
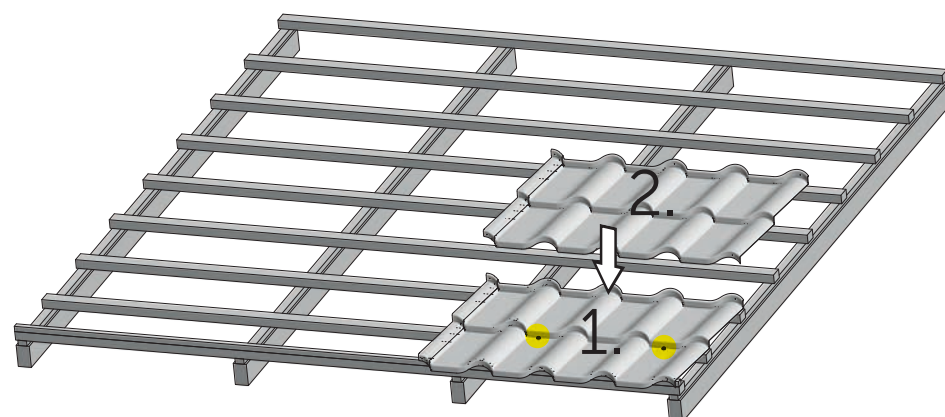

4.

Joining the sheets together using TORX LP 4,8 x 23 screws or 4,8 x 19 farmer screws for metal.

5.

Installation of the remaining part of the sheet strip.

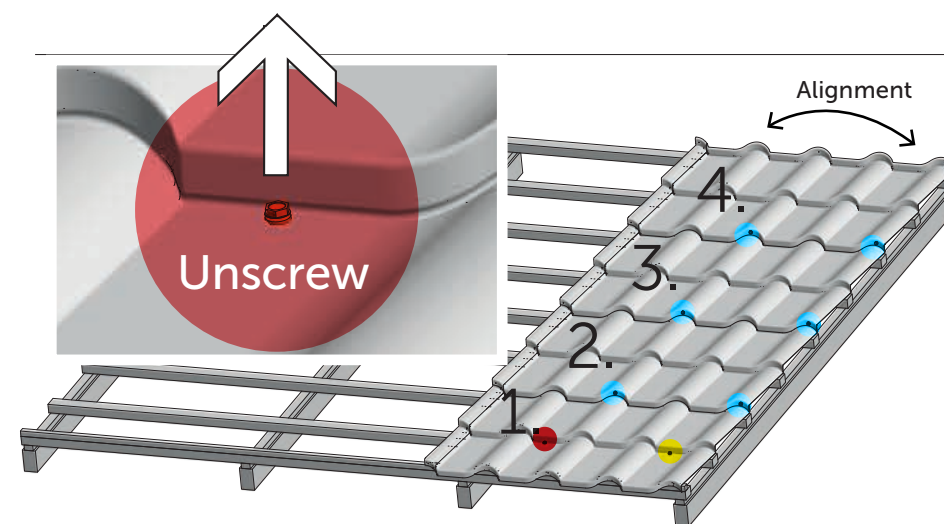
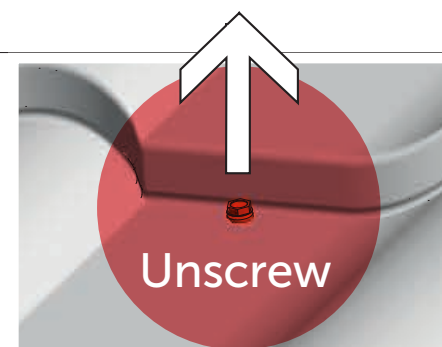
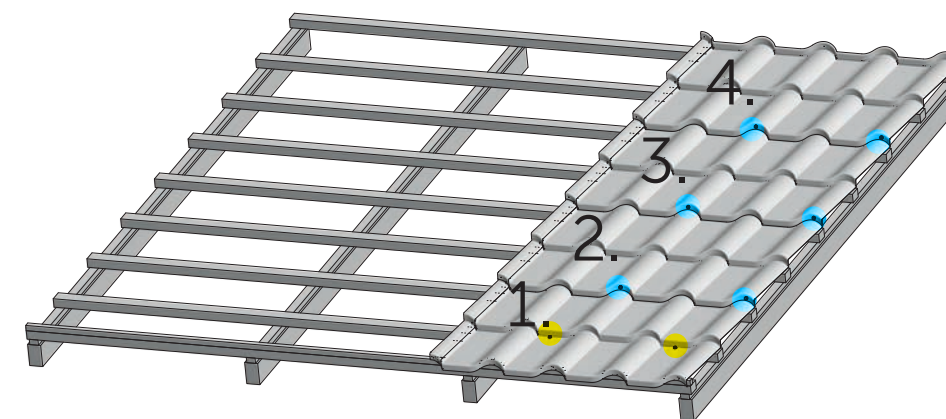

6.

Aligning the sheet strip with the roof surface.

7.

Fixing one sheet strip to the battens and laying the first sheet in the subsequent strip.

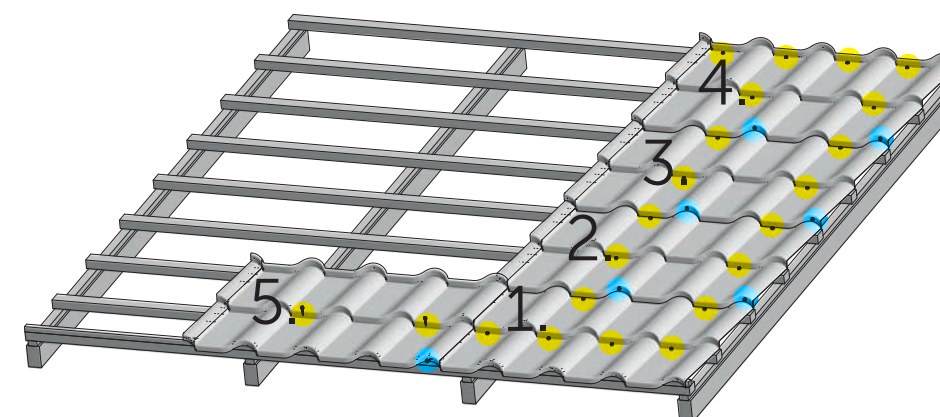
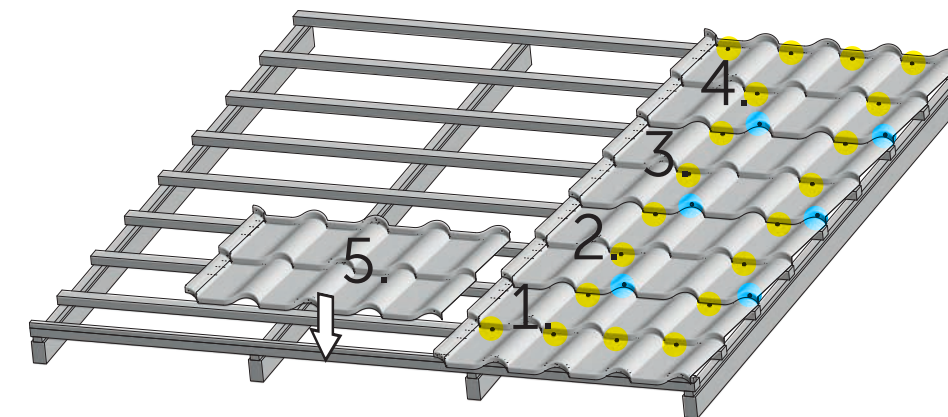

8.

Joining sheets and fixing to battens.

9.

Installation of the remaining part  
of the sheet strip.

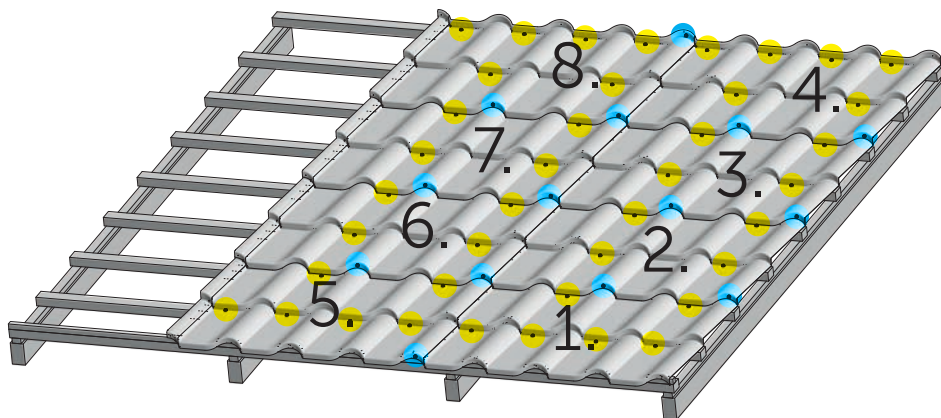

## INSTALLATION OF THE RIDGE CAP

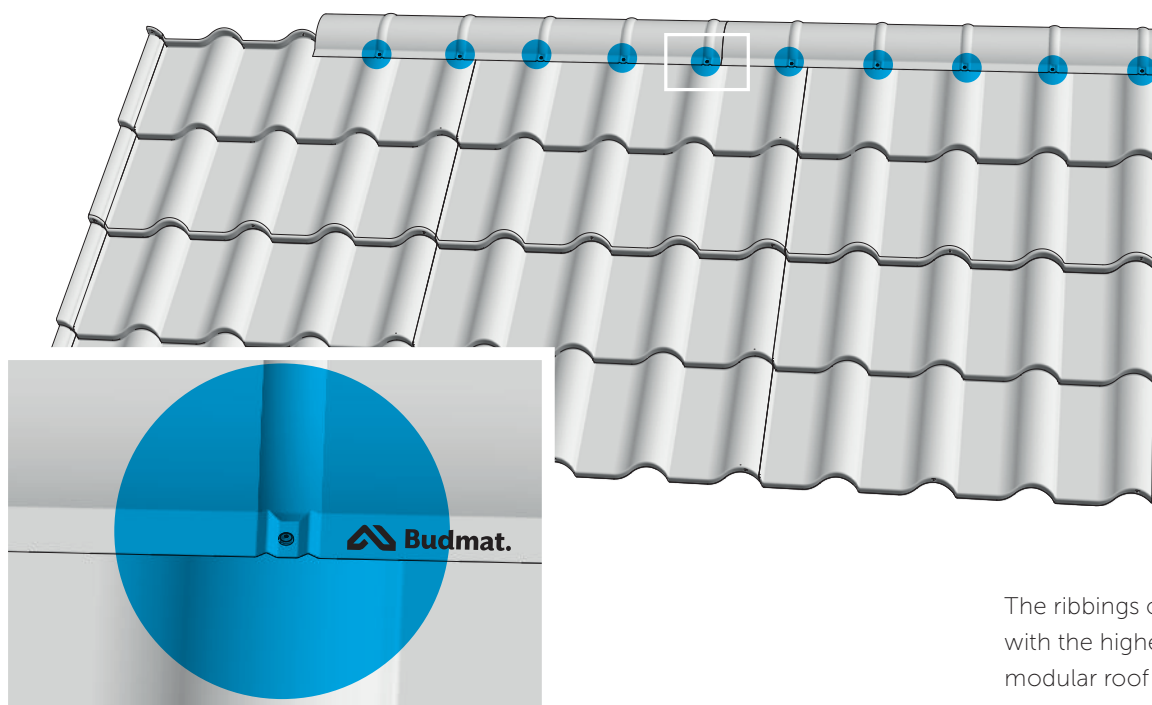

The ribbings of the ridge tile should flush  
with the highest points of the Ferrara  
modular roof tile sheet.  
Embossed logo is a confirmation  
of the authenticity of the product.